

**16 CLEANING**

**16.1 GENERAL WARNINGS FOR CLEANING**

It is forbidden to:

- use water jets to clean the machine;
- use detergents containing alcohol, ammonia or abrasive sponges to clean the machine; use only specific detergents for coffee machines or dishwashers.
- Chemical detergents for machine and/or system cleaning must be used with care to prevent wear of the components and damage to the environment (biodegradability above 90%).
- Clean all parts and components of the machine fully.
- Cleaning and maintenance to be performed by the user must not be done by children without supervision.



**ATTENTION:** Maintenance operations must be performed with the machine off and cold and with the main switch set to "0" OFF. For particular maintenance operations to be carried out with the machine in operation, proceed with great caution.



**ATTENTION:** When carrying out regeneration or maintenance operations on the decalcifier, follow the instructions in the relevant manual.

**16.2 ROUTINE MAINTENANCE**

Ordinary maintenance includes all the interventions that must be carried out on the machine every day at the end of the service.

**16.2.a UNIT MANUAL WASHING**



**IMPORTANT:** all units of the machine must be washed. The duration of the cleaning cycle is about 3 minutes.

- Remove the filter holder and empty it.
- Remove the filter (1) and insert the blind filter (2), pour specific detergent for coffee machines into the blind filter; for the quantity, follow the instructions on the detergent package.

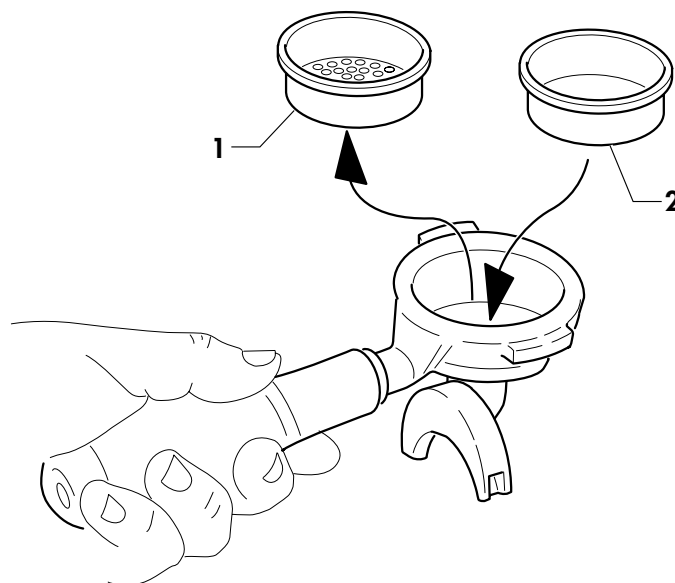

- Reassemble the filter holder in the machine and press button (E) and then (A), always keeping button (E) of the button panel of the unit you are referring to pressed. The unit washing cycle will start automatically, LEDs (A) and (E) will light up flashing and the message "CL" will appear on the display.



- Remove the filter holder and clean the blind filter, washing it with running water.
- Refit the filter holder in the unit and repeat the washing stage without pouring detergent in the blind filter; a rinsing stage is then performed.

At the end of the rinsing phase disassemble and remove the filter holder, replace the blind filter with the normal filter and dispense a coffee to eliminate any unpleasant flavours.

It is possible to interrupt the manual unit washing in progress by pressing any button of the unit concerned.

## 16.2.b UNIT AUTOMATIC WASHING

To activate the automatic washing of all the units, see the specific function in PROGRAMMING in the paragraph TECHNICAL USER MENU.

## 16.2.c DAILY MACHINE CLEANING



**WARNING: DO NOT use corrosive or abrasive detergents, use only detergents specifically for cleaning coffee machines or cleaning dishes.**

**DO NOT clean the machine using water jets.**

For cleaning, proceed as follows:

- remove the filter holders and empty them;
- remove the filters from their holders and immerse both in a basin containing a specific detergent, leaving them to soak for as long as the machine is not used;

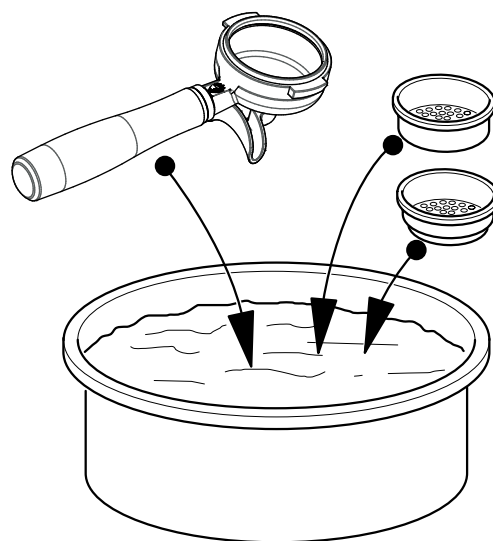
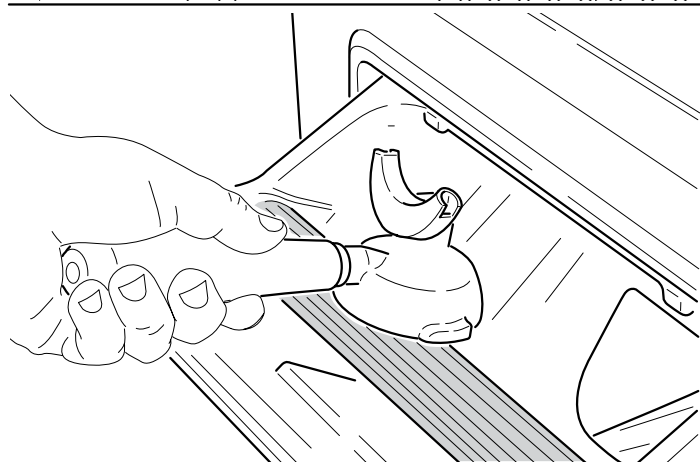
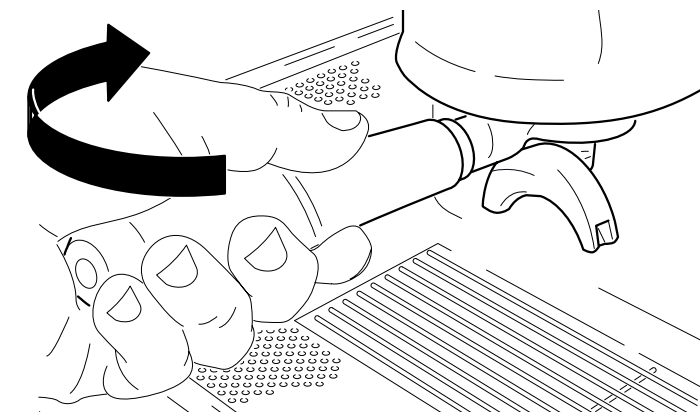

- remove the grille and wash it with running water and specific detergents;
- after washing it, dry it completely with a soft cloth and reassemble it.

- Check the steam wands to make sure they are not encrusted, if necessary clean them using specific detergents.



**16.3 SCHEDULED MAINTENANCE (TECHNICIAN)**

Scheduled maintenance lists all the operations that must be carried out on a fixed schedule to ensure the correct operation of the machine.



**IMPORTANT:** all scheduled maintenance operations must be carried out by a technical service centre. It is advisable to stipulate a maintenance contract with the local technical assistance centre for any inconvenience that may occur while using the machine.



**16.4 MAINTENANCE AS REQUIRED (TECHNICIAN)**

It lists certain operations that must be performed when necessary, such as replacing a worn or broken component.



**IMPORTANT:** Any problem not included in the table in chapter 13 must be referred to the technical assistance centre.

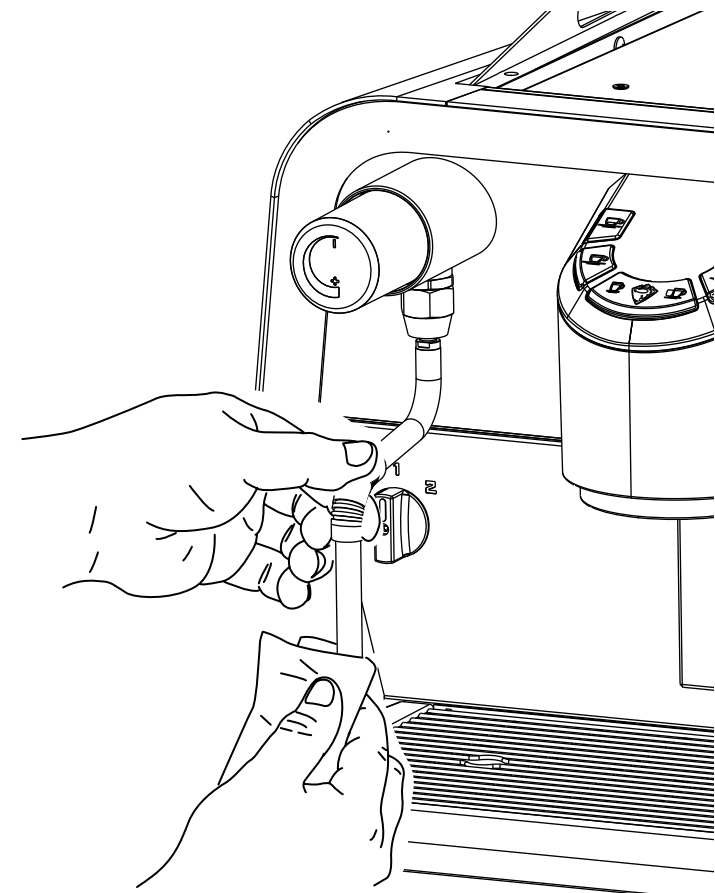

- Clean the lower part of the unit with a sponge and with a soft bristle brush clean the gasket (3).

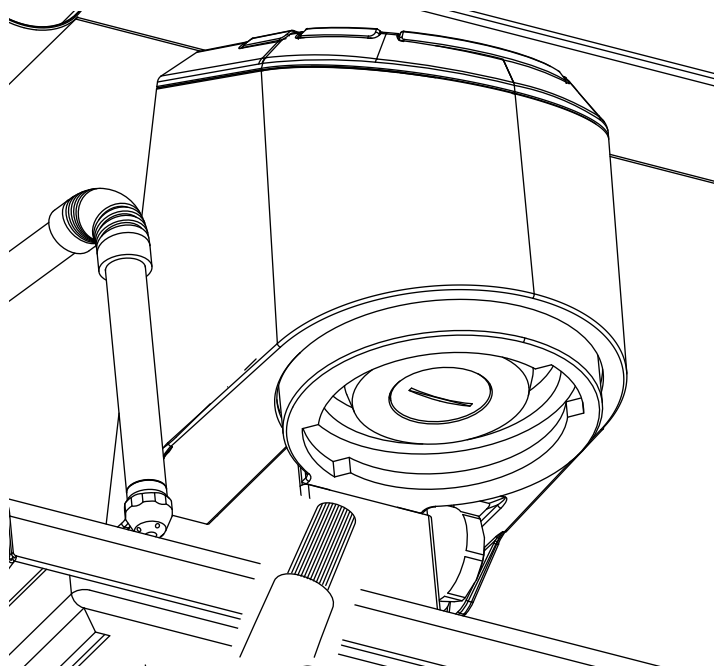

- Clean the outside of the machine using a cloth moistened with water.