

X64 SD

ORIGINAL OPERATING INSTRUCTIONS

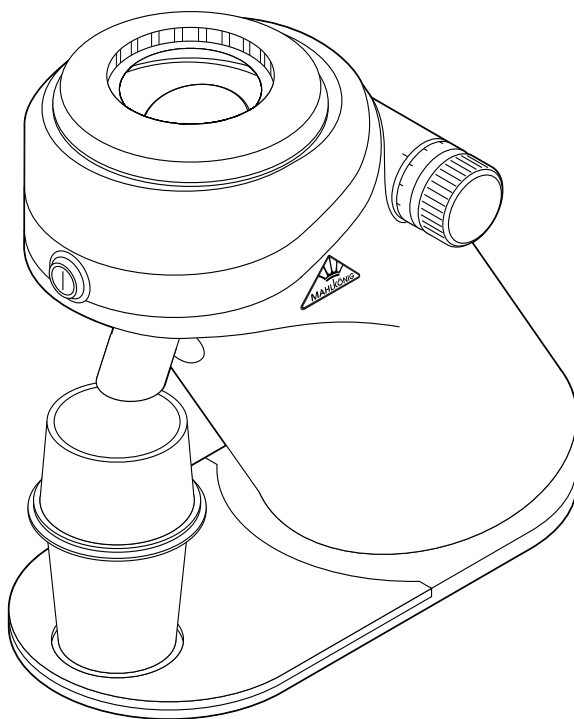

Contents

Overview ...	3	Optional accessories ...	20
Scope of delivery / parts .	5	Troubleshooting ..	21
General information ...	6	Technical data ..	23
Read and keep the operating instructions ...	6	Declaration of conformity ..	24
Explanation of characters used...	6	Maintenance and service ...	24
Security .	7	Waste disposal .	25
Intended use ..	7	Dispose of packaging ...	25
Safety instructions.	8	Dispose of the grinder..	25
How the grinder works ...	11		
Initial commissioning ..	12		
Check grinder and scope of delivery ...	12		
Select installation location ...	12		
Set up and connect the grinder...	13		
Before first use ..	13		
Use grinder ...	14		
Inserting / removing hopper attachments .	14		
Insert hopper attachment ...	14		
Removing the hopper attachment..	14		
Fill with beans ...	14		
Setting the grinding degree .	15		
Start/stop grinding ...	16		
Start grinding..	16		
Stop grinding..	16		
Use single-dose bellows (change the type of coffee bean) ...	16		
Cleaning ...	17		
Cleaning the grinder base ...	17		
Clean the grinder...	18		
Cleaning the outlet system ..	18		
Cleaning the hopper and hopper attachments .	19		
Cleaning the grinder .	19		

Overview

i

All illustrations are exemplary. Your grinder may differ visually in minor details.

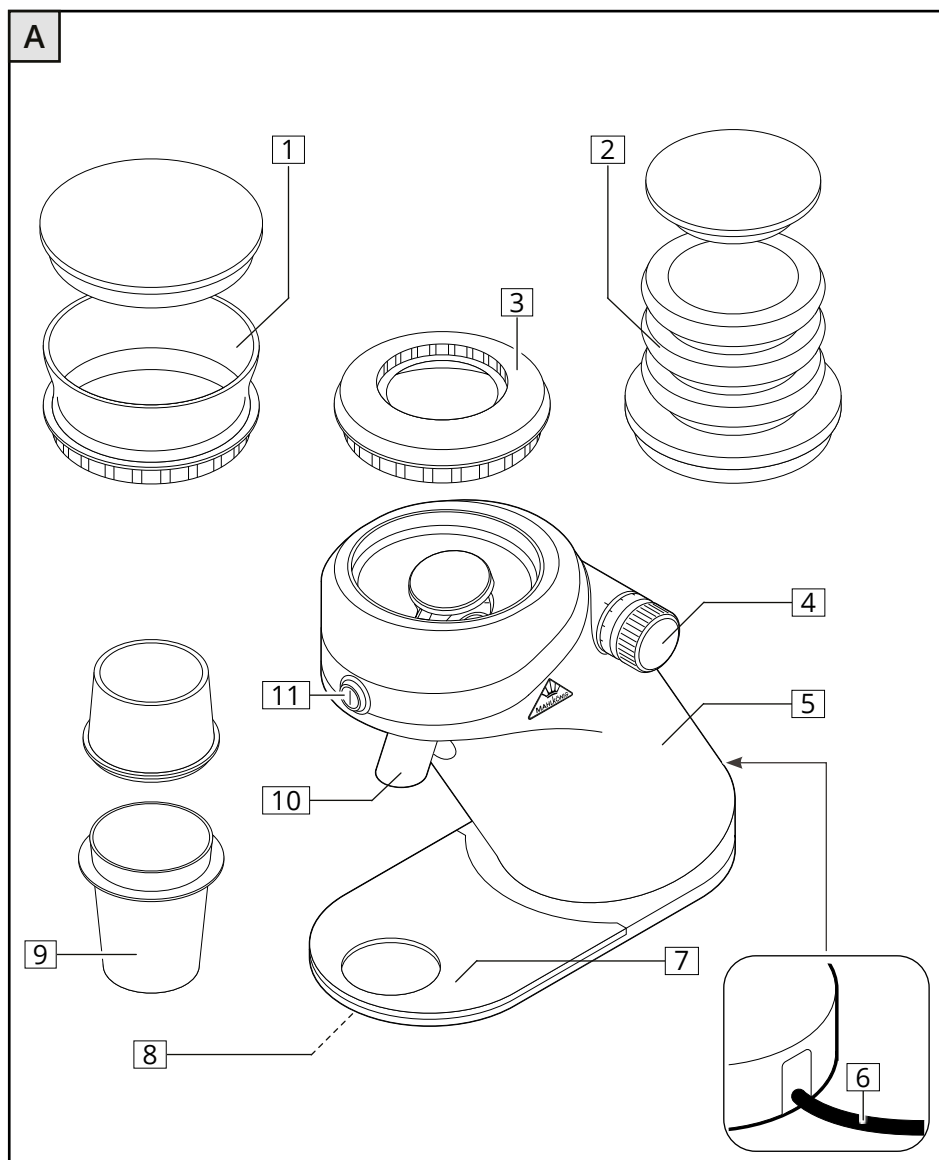

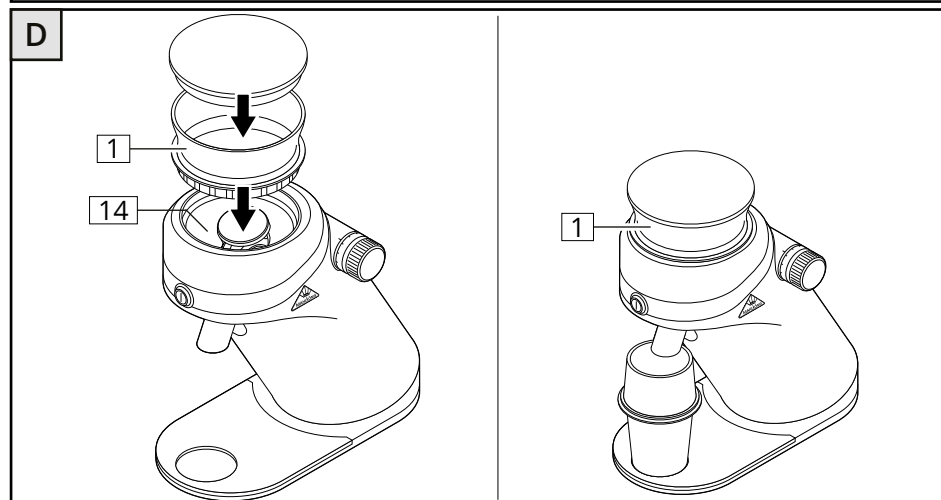
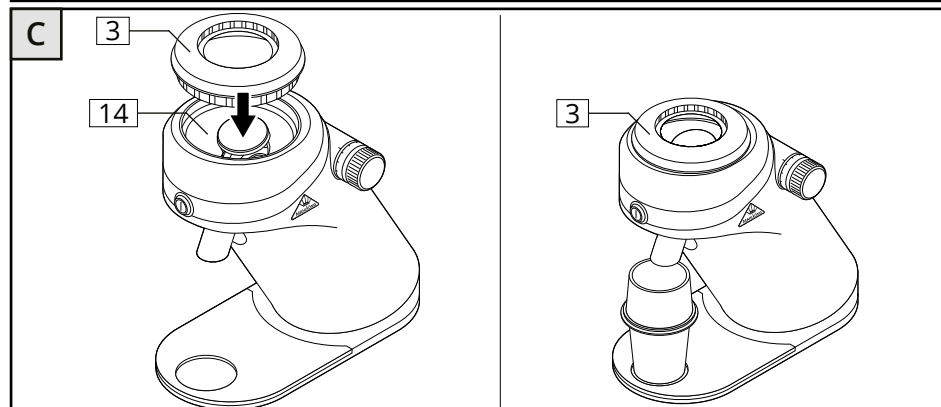
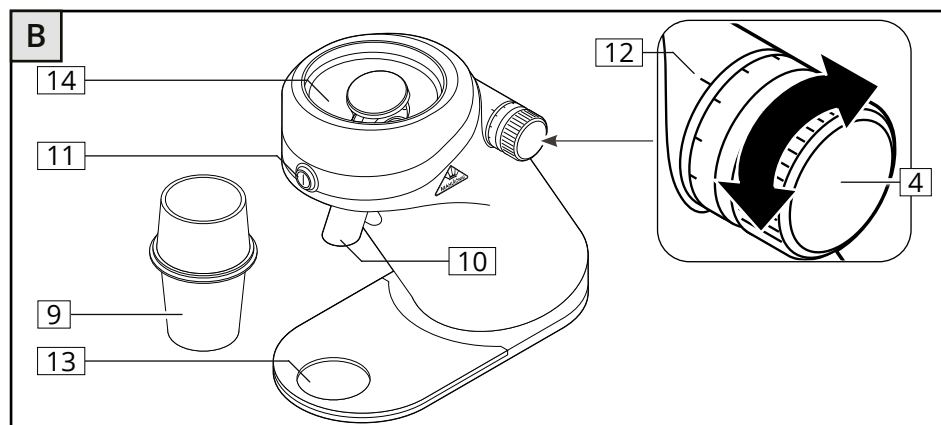

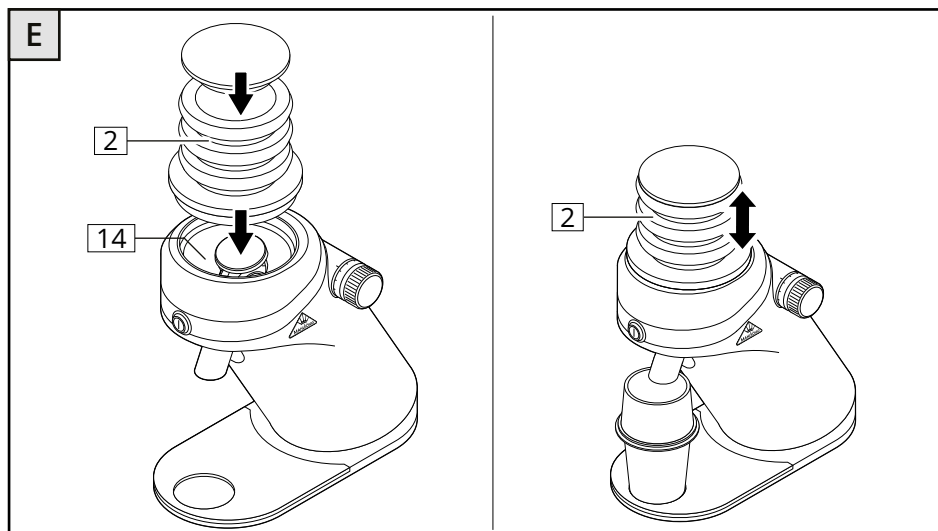

Scope of delivery / parts

No.	Designation	
1	Hopper extension (with lid)	Hopper attachments
2	Single-dose bellows (with lid)	
3	Anti-Popcorning-Attachment	
4	Adjusting wheel (with grinding degree scale)	
5	Grinder carcass	
6	Mains cable (with mains plug)	
7	Drip tray	
8	Feet (rubberized)	
9	Dosing cup (with attachment)	
10	Outlet	
11	START/STOP button	
12	Marking (grinding degree setting)	
13	Deepening (dosing cup)	
14	(Bean) hopper / <i>hopper</i>	

General information

Read and keep the operating instructions



This document is the original operating instructions for the Coffee grinder X64 SD.*

Before using the grinder, read these operating instructions carefully, especially the safety instructions. Only then can you operate the grinder safely and use all functions optimally and as intended.

These operating instructions are based on the standards and regulations applicable in the European Union. When abroad, also observe country-specific guidelines and laws.

Always keep these operating instructions to hand for future reference and pass them on with the grinder to any subsequent owners or other users.

Explanation of characters used

The following symbols and signal words may be used in these operating instructions, on the grinder or on the packaging.



WARNING!

This signal word/symbol indicates a hazard with a medium level of risk which, if not avoided, could result in death or serious injury.



CAUTION!

This signal word/symbol indicates a hazard with a low level of risk which, if not avoided, may result in minor or moderate injury.

PLEASE NOTE!

This signal word warns of possible material damage.



This symbol gives you useful information on operation or handling.



EU Declaration of Conformity: Products marked with this symbol comply with all applicable Community regulations of the European Economic Area.



UKCA seal of approval: Products marked with this symbol meet the electrical product safety requirements of the United Kingdom of Great Britain.

* For better readability, the Coffee grinder X64 SD will be referred to as the "grinder" and the original operating instructions as the "operating instructions".



ETL Listed seal of approval: Products marked with this symbol meet the electrical product safety requirements of the United States of America.



Products marked with this symbol meet the required criteria of the NSF (National Sanitation Foundation) with regard to cleanliness and hygiene in the food sector.



Products marked with this symbol may only be used indoors.



This symbol indicates a risk of electric shock.



This symbol indicates that the grinder complies with protection class I.

Security

Intended use

The grinder is designed exclusively for grinding whole roasted espresso or coffee beans and may only be used for this purpose. Do not use the grinder to grind other products or objects and do not make any (technical) modifications to the grinder.

The grinder is intended for use in private households or in the home.

The grinder is expressly not designed for use for commercial purposes (gastronomy), but you can use the grinder in commercial facilities in a domestic environment. This includes, for example, stores, offices or similar work environments and farms where employees use the grinder, and hotels, motels and other typical residential environments or bed and breakfasts where guests use the grinder.

Any other use or manipulation of the grinder is considered improper and may result in damage to property or even personal injury.

Neither the manufacturer nor the dealer shall be liable for injuries and damage resulting from improper use and/or failure to observe the safety instructions.

Safety instructions

WARNING!

Risk of electric shock!

Improper use, faulty electrical installation or excessive mains voltage can lead to electric shock.

- Only connect the grinder if the mains voltage of the socket matches the specification on the rating plate.
 - Only connect the grinder to an easily accessible socket so that you can quickly disconnect it from the power supply in the event of a fault.
 - Do not operate the grinder if it is visibly damaged or if the mains cable or mains plug is defective.
 - If the mains cable of the grinder is damaged, it must be replaced by the manufacturer or by qualified personnel in order to avoid hazards.
 - Do not immerse the grinder, mains cable or mains plug in water or other liquids.
 - Keep liquids away from the grinder, the mains cable and the mains plug. Also ensure, for example, that the grinder is not exposed to splashing water at the installation site.
 - Never touch the mains plug with wet hands.
 - Never pull the mains plug out of the socket by the mains cable; always hold the mains plug.
 - Never use the mains cable as a carrying handle.
 - Keep the grinder and the mains cable or mains plug away from naked flames and hot surfaces.
 - Do not kink the mains cable and do not lay it over sharp edges.
 - Only use the grinder indoors. Never operate the grinder in damp rooms or in the rain.
 - If you are not using the grinder, cleaning it or if a fault occurs, switch off the grinder and disconnect the mains plug from the socket.
-

WARNING!

Dangers for children and persons with reduced physical, sensory or mental abilities (e.g. partially disabled persons, older persons with reduced physical and mental abilities) or lack of experience and knowledge (e.g. older children).

- The grinder is not intended for use by children or persons with reduced physical, sensory or mental capabilities or lack of experience and knowledge.
 - Always keep the grinder away from children. Children are not allowed to use or play with the grinder.
 - Make sure that small children in particular cannot reach the power cable. If small children pull on the power cable, they can be seriously injured by the falling grinder.
 - Do not leave the grinder unattended during operation.
 - Do not allow children to play with the packaging film. Children can get caught in them while playing and suffocate.
 - Do not allow children to play with the small parts. The small parts can be life-threatening if swallowed.
-

CAUTION!

Risk of tipping and injury!

Improper handling of the grinder can lead to injuries.

- Place the grinder on a level and stable surface so that it cannot fall down.
 - Lay the mains cable so that it does not become a tripping hazard/ no one can get caught in it and cause the grinder to fall.
-

PLEASE NOTE!

Risk of damage!

Improper handling can damage the grinder.

- Only ever lift the grinder by the grinder body and always with both hands.
- Make sure that children do not put any objects into the grinder.
- Do not open the housing, but leave the repair to specialists. Contact a specialist workshop for this.

Liability and warranty claims are excluded in the event of repairs carried out by the user, improper connection or incorrect operation. Only parts that correspond to the original device data may be used for repairs. This grinder contains electrical and mechanical parts that are essential for protection against sources of danger.

How the grinder works

The grinder is primarily designed for grinding small portions / single portions. The protective cover in the hopper **[14]** prevents direct access to the grinder and thus prevents injuries (e.g. from accidentally reaching into it).

You can use the grinder to grind both espresso beans and coffee beans to different grind sizes (fine - coarse) (see S. 15 "*Setting the grinding degree*"). Use the adjusting wheel on the side **[4]** to set the grinding degree.



IMPORTANT: The grinding degree should only be adjusted in larger steps when the motor is running.

If you adjust the grinding degree in large steps while the grinder is at a standstill, this can lead to a mechanical overload during the subsequent grinding process. In the worst case, this can damage the grinding disks, the motor and the gearbox parts.

Use the dosing cup **[9]** to weigh and fill the coffee beans and to collect the ground coffee*. You can also close the dosing cup for collecting the ground material with the corresponding attachment. This prevents the ground food from spraying sideways.

You control the grinding time manually by pressing the START/STOP button **[11]**. The maximum grinding time is 6 seconds per minute.

* Ground coffee = the ground espresso/coffee powder

Initial commissioning

Check grinder and scope of delivery

PLEASE NOTE!

Risk of damage!

If you open the packaging carelessly with a sharp object (e.g. a knife) or if you do not handle the grinder correctly when lifting it out of the packaging, the grinder may be damaged.

- Be very careful when opening.



IMPORTANT: Always hold the grinder by the grinder body [5] and always with both hands when lifting the grinder out of the packaging or when moving / rearranging the grinder.

1. Remove the grinder and all accessories from the packaging.
2. Check that the delivery is complete (see **Fig. A**).
3. Check whether the grinder or individual parts are damaged. If this is the case, do not use the grinder.

In this case, contact the dealer from whom you purchased the grinder directly or the customer service for Grinding kingproducts (see S. 24 "Maintenance and service").

Select installation location

Select a location for the grinder that meets the following criteria:

- level, stable and vibration-free footprint;
- Non-slip and dry surface;
- Socket for the power connection within easy reach;
- The grinder and power cable are out of reach of small children.



IMPORTANT: Some cleaning agents contain ingredients that attack the rubberized feet [7] of the grinder. This causes the grinder to lose stability.

- » Therefore, only use water and mild detergents to clean the surface.

Set up and connect the grinder



IMPORTANT: Always hold the grinder by the grinder body [5] and always with both hands when moving / repositioning the grinder.

1. Place the grinder in the desired location.
The grinder must stand securely on the rubberized feet [8] and must not wobble (see **Fig. A**).
2. Attach the spout [10] to the grinder by carefully pushing it upwards in the holder until the lock engages.
Make sure that the nose on the holder slides into the groove on the outlet.
3. Place the drip tray [7] on the front of the grinder in the housing recess below the outlet.
The drip tray is held magnetically in the correct position in the housing recess.
4. Insert the desired hopper attachment (see S. 14 *"Insert hopper attachment"*).
5. Connect the grinder to the mains by inserting the mains plug [6] into a properly installed earthed socket.

Before first use



The grinder was subjected to an extensive function test before delivery and may therefore still contain coffee powder residues.

1. Grind a small portion of espresso or coffee beans before using for the first time.
2. Remove any remaining coffee powder and production-related residues from the hopper [14] and the grinder using the single-dose bellows [2] (see S. 16 *"Use single-dose bellows (change the type of coffee bean)"*).

Use grinder

Inserting / removing hopper attachments

Insert hopper attachment

- » Place the desired hopper attachment (hopper extension **[1]**, single-dose bellows **[2]**, anti-popcorning attachment **[3]**) from above onto the hopper **[14]** (see **Fig. C-E**).

Make sure that the respective hopper attachment slides straight into the hopper from above and sits correctly.

Removing the hopper attachment

- » Remove the hopper attachment from the top of the hopper.

Fill with beans

1. Fill the desired amount of beans (espresso or coffee beans) into the dosing cup **[9]**.

For an ideal result / the ideal dosage, weigh the amount of beans using a (digital) coffee scale.

2. Fill the beans from the dosing cup through the filler opening of the hopper attachment used (hopper extension **[1]** / anti-popcorning attachment **[3]**) from above into the hopper.

When using the hopper extension **[1]**:

3. Close the filler opening of the hopper extension using the lid.

Setting the grinding degree

i

You can use the adjusting wheel [4] to set the desired degree of grinding.

The lowest setting on the grinding degree scale is "1" (for very fine grinds), the highest setting is "12" (for very coarse grinds).

As a guide for setting the grind level, three preparation types (espresso, filter, cold brew) are marked on the grind level scale at the level of their grind level range (see **illustration on the right**).

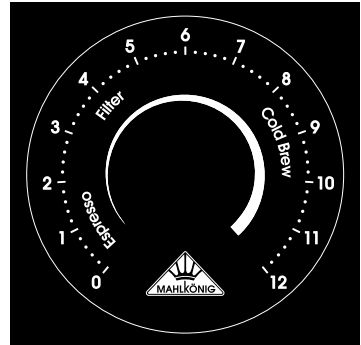

Turn the adjusting wheel [4] so that the marking [12] points to the desired value on the grinding degree scale (see **Fig. B**).

Turn clockwise:

Increase the value on the grinding degree scale (= for coarser grind)

Turn counterclockwise:

Reduce the value on the grinding degree scale (= for finer grind).

i

IMPORTANT: The grinding degree should only be adjusted in larger steps when the motor is running.

If you adjust the grinding degree in large steps while the grinder is at a standstill, this can lead to a mechanical overload during the subsequent grinding process. In the worst case, this can damage the grinding disks, the motor and the gearbox parts.

Start/stop grinding

Start grinding

1. Place the dosing cup (with the attachment fitted) **[9]** in the intended position below the spout **[10]** (see **Fig. A**).

There is a slight depression **[13]** in the drip tray **[7]** at the intended position (see **Fig. B**).

The container opening must be centered under the outlet.

2. Press the START/STOP button **[11]** to start the grinding process.

The START/STOP button locks, grinding starts.

Stop grinding

- » Press the START/STOP button **[11]** again to stop the grinding process.

The START/STOP button is released and grinding stops.

Use single-dose bellows (change the type of coffee bean)



Use the single-dose bellows **[2]** to blow any remaining coffee powder out of the hopper **[14]**.

This allows you to change the bean type and enjoy the unadulterated aroma of the desired espresso or coffee bean type without having to go to great lengths or clean the grinder.

1. Place the single-dose bellows **[2]** on the hopper **[14]** from above (see **Fig. E**).

Make sure that the single-dose bellows slides straight into the hopper from above and sits correctly.

2. Close the single-dose bellows at the top using the lid.
3. Pump by pressing on the single-dose bellows from above and then letting it slide back up again.

Repeat the process several times to completely remove (blow out) the remaining coffee powder from the hopper **[14]** and the grinder.

Cleaning

CAUTION!

Risk of injury!

The grinder may fall when you move it and injure you.

- Always place the grinder on a stable surface that cannot tip over.

PLEASE NOTE!

Danger of short circuit!

Water entering the grinder can cause a short circuit.

- Never immerse the grinder in water or other liquids.
- Never clean the grinder with a jet of water or a steam cleaner.
- Make sure that no water or other liquids get into the housing.
- Do not clean the grinder using compressed air (e.g. with a compressed air blow gun).

PLEASE NOTE!

Risk of damage!

Improper handling can lead to damage to the grinder.

- Do not use any aggressive cleaning agents or sharp or metallic cleaning objects such as knives, metal sponges and the like. These can scratch the surface.
- Do not put the drip tray, the spout or the hopper attachments (incl. lid) in the dishwasher. The parts are not suitable for this and the color may fade.
- Only ever lift the grinder by the grinder body and always with both hands.

Cleaning the grinder base

1. Pull the mains plug [6] out of the socket.
2. Lift the grinder with both hands by the grinder body and place it on a clean surface.
3. Clean the base and the underside of the grinder with a damp cloth and dry the surfaces.

The surfaces must be dry and free of oil and grease.



Some cleaning agents contain ingredients that attack the rubberized feet **[7]** of the grinder. This causes the grinder to lose stability.

» Therefore, only use water and mild detergents to clean the surface.

4. Place the grinder back on the cleaned surface.

Clean the grinder



Clean the grinder as required, but at least once a week as described below.

1. Pull the mains plug **[6]** out of the socket.
2. If necessary, remove the hopper attachment from the hopper **[14]** (see *S. 14 "Removing the hopper attachment"*).

Clean the hopper and the hopper attachments as described in the corresponding chapter (see *S. 19 "Cleaning the hopper and hopper attachments"*).

3. Pull the spout **[10]** forwards / downwards away from its holder.
Clean the spout and its holder as described in the corresponding chapter (see *S. 18 "Cleaning the outlet system"*).
4. Pull the drip tray **[7]** forwards away from the grinder.
5. Wipe the grinder body **[5]** and the drip tray with a damp cloth.
6. Then dry the grinder and all cleaned parts.

The grinder and all parts attached to it must be completely dry before being used again.

7. Reattach all parts removed for cleaning.

Cleaning the outlet system



The outlet system should be cleaned once a week (or as required).

The manufacturer recommends using a brush with nylon bristles to clean the outlet system.

1. Pull the spout **[10]** forwards / downwards away from its holder.
2. Use a brush to clean the outlet on the grinder (= outlet holder).
3. Clean the spout with a damp cloth and then dry it.
4. Reattach the spout to the grinder by carefully pushing it upwards in the holder until the lock engages.



IMPORTANT: Take care not to damage the surface of the spout.

Fine scratches can have a negative effect on the grinding result, as ground coffee sticks to the scratches, which can lead to fluctuations in the dosage.

Cleaning the hopper and hopper attachments



The hopper and the hopper attachments used should be cleaned regularly once a week (or as required) to remove coffee oil residues, as these residues can have a negative effect on the taste.

1. Remove the hopper attachment from the top of the hopper **[14]** (see S. 14 “*Removing the hopper attachment*”).
2. Wipe the hopper **[14]** and the protective cover inside it with a slightly damp, well-wrung cloth.

IMPORTANT: No liquid from the hopper may get into the grinder below.

3. Rinse the hopper attachments in warm water.

Use a mild cleaning agent if necessary.

4. Then dry the hopper and the cleaned hopper attachments.

The hopper and the hopper attachments must be completely dry before being used again.

Cleaning the grinder



The grinder should be cleaned every 2-5 days.

The manufacturer recommends the use of the grinder cleaner GRINDZ™. Further information on GRINDZ™ can be found at www.mahlkoenig.com.



For cleaning the grinder, set the highest value on the grinding degree scale (for the coarsest possible grind).

1. If necessary, remove the hopper attachment from the hopper **[14]** (see S. 14 “*Removing the hopper attachment*”).
2. Fill the grinder cleaner directly into the hopper from above.
Follow the manufacturer's instructions for the quantity of grinder cleaner used.
3. Place a suitable collecting container under the outlet **[10]** to collect the grinder cleaner.

4. Start grinding the grinder cleaner (see S. 16 *"Start grinding"*).

IMPORTANT: Let the grinder run until the grinder cleaner is completely ground.

5. Stop the grinding (see S. 16 *"Stop grinding"*).
6. Then grind about the same amount of coffee beans as the grinder cleaner to remove any remaining cleaning particles.
7. Dispose of the ground grinder cleaner and the ground coffee beans in the residual waste.

Optional accessories

Mahlkönig is constantly working on further developing its existing products and opening up new avenues for coffee lovers worldwide through technical innovations. In terms of user satisfaction and sustainability, it is particularly important to us that our existing products can be retrofitted with new technologies and accessories (where possible). So you too can benefit from our (future) innovations.

- » Simply visit our homepage **www.mahlkoenig.com**.

With a bit of luck, you will discover **brand new** optional **accessories** for your grinder and may be able to tailor it even better to your personal taste - **for your** very individual **coffee enjoyment**.

You can find detailed information on the optional accessories available for your grinder on our website at:

https://hemro.net/X64SD_Product

Troubleshooting

Error	Cause	Remedy
The grinder does not grind.	<ul style="list-style-type: none"> • The mains plug is not plugged in. 	» Insert the mains plug into a properly installed socket.
The grinder hums, but does not grind.	<ul style="list-style-type: none"> • The grinder is clogged. • Coffee grounds have accumulated in the grinder due to overdosing in the portafilter. • The grind is too fine. • There is a foreign object in the grinder. 	<ol style="list-style-type: none"> 1. Set the highest value on the grinding degree scale (for the coarsest possible grind). 2. Start the grinding process. The grinder grinds freely. 3. Then set the desired grinding degree during operation. 4. Stop the grinding process. <p>» Contact the customer service for Mahlkönig products (see S. 24 <i>"Maintenance and service"</i>).</p>
The grinder does not grind fine enough.	<ul style="list-style-type: none"> • The grinding disks are worn or need to be readjusted. 	» Contact the customer service for Mahlkönig products for a grinding disk replacement (see S. 24 <i>"Maintenance and service"</i>)
The grinder does not grind continuously, the grinder interrupts the grinding process.	<ul style="list-style-type: none"> • Coffee beans form a bridge in front of the grinder inlet. The coffee beans do not slip. 	» Clean the grinder (see S. 19 <i>"Cleaning the grinder"</i>).
The grinder does not dose centrally into the dosing cup.	<ul style="list-style-type: none"> • The outlet is blocked. 	» Clean the outlet system (see S. 18 <i>"Cleaning the outlet system"</i>).

Error	Cause	Remedy
The hopper attachment cannot be fitted.	<ul style="list-style-type: none"> • There is coffee powder or small bean particles on the inside of the hopper or the outside of the hopper attachment. 	<ul style="list-style-type: none"> » Clean the hopper and the hopper attachment (see S. 19 <i>"Cleaning the hopper and hopper attachments"</i>).
The dosing accuracy of the grinder decreases.	<ul style="list-style-type: none"> • The outlet is blocked. Too much ground coffee has built up inside the grinder. 	<ol style="list-style-type: none"> 1. Clean the outlet system (see S. 18 <i>"Cleaning the outlet system"</i>). 2. Set the highest value on the grinding degree scale (for the coarsest possible grind). 3. Start the grinding process. The grinder grinds freely. 4. Then set the desired grinding degree during operation. 5. Stop the grinding process.
	<ul style="list-style-type: none"> • The grinder outlet is damaged. 	<ul style="list-style-type: none"> » Contact the customer service for Mahlkönig products (see S. 24 <i>"Maintenance and service"</i>).

Technical data

Model:	X64 SD
Voltage Frequency:	100 V 50/60 Hz 120 V 60 Hz 220-240 V 50/60 Hz
Protection class:	IPX1
Protection class:	I 
Acoustic emission value (during grinding):	65 dBA
Grinding capacity (fine-coarse):	2.5-6 g/s*
Max. permissible operating cycle	6 sec. on / 54 sec. off
Recommended break:	54 sec.
Max. daily output:	2.5 kg*
Dimensions (W × H × D) (without hopper attachment):	approx. 143 × 249 × 253 mm
Weight (net):	approx. 4.8 kg
Max. Filling quantity of the hopper attachments	
Anti-Popcorning essay [3] :	approx. 30 g
Hopper extension [1] :	approx. 100 g
Single-dose bellows [2] :	approx. 80 g

* The grinding capacity and the maximum daily output depend on the selected espresso/ coffee bean type, the selected grinding degree and the mains voltage/frequency.

Declaration of conformity

Hemro International AG hereby declares that the grinder complies with Directive 2014/53/EU and the other relevant requirements for obtaining the CE marking* .

The full text of the declaration of conformity can also be found at:

https://hemro.net/X64SD_Certificates

Maintenance and service

- » In the event of service or maintenance, contact an authorized customer service center for Grinding king-products.

Customer service will answer your questions about repair and maintenance of your product as well as spare parts.

Exploded views and information on spare parts can also be found at:

https://hemro.net/X64SD_Product

Our application consulting team will be happy to help you with questions about our products and their accessories.

- » For all queries and spare parts orders, please be sure to quote the article and serial number on the grinder's rating plate.

* See S. 6 "Explanation of characters used".

You can also find helpful information about handling the grinder in the videos on the X64 SD on the YouTube channel of Grinding king can be found on the YouTube channel.

- » Scan (or click) the following QR code to go directly to the YouTube channel with videos about the X64 SD to get there:

https://hemro.net/X64SD_Service_PlaylistYouTube

Waste disposal

Dispose of packaging



Dispose of the packaging according to type. Put cardboard and carton in the waste paper bin and foil in the recycling bin.

Dispose of the grinder



Electrical appliances are marked with the adjacent symbol. Old appliances must not be disposed of in commercial/household waste!

Consumers are legally obliged to dispose of old appliances separately from commercial/household waste, e.g. at a collection point in the municipality/district, for the purpose of recycling or disposal. It is also possible to return the old appliance to the retailer free of charge. This ensures that old appliances are recycled properly and negative effects on the environment are avoided. If personal data is stored on the old device, consumers must ensure that it is deleted themselves.

HEMRO

Hemro International AG

Thurgauerstrasse 80 | 8050 Zurich, Switzerland

T: +41 44 864 18 00 | F: +41 44 864 18 01

info@hemrogroup.com | www.hemrogroup.com